

© Crown copyright and database rights 2013 Ordnance Survey 100019422  
 You are not permitted to copy, sub-license, distribute or sell any of this data to third parties in any form.  
 Produced by Staffordshire County Council, 2013.

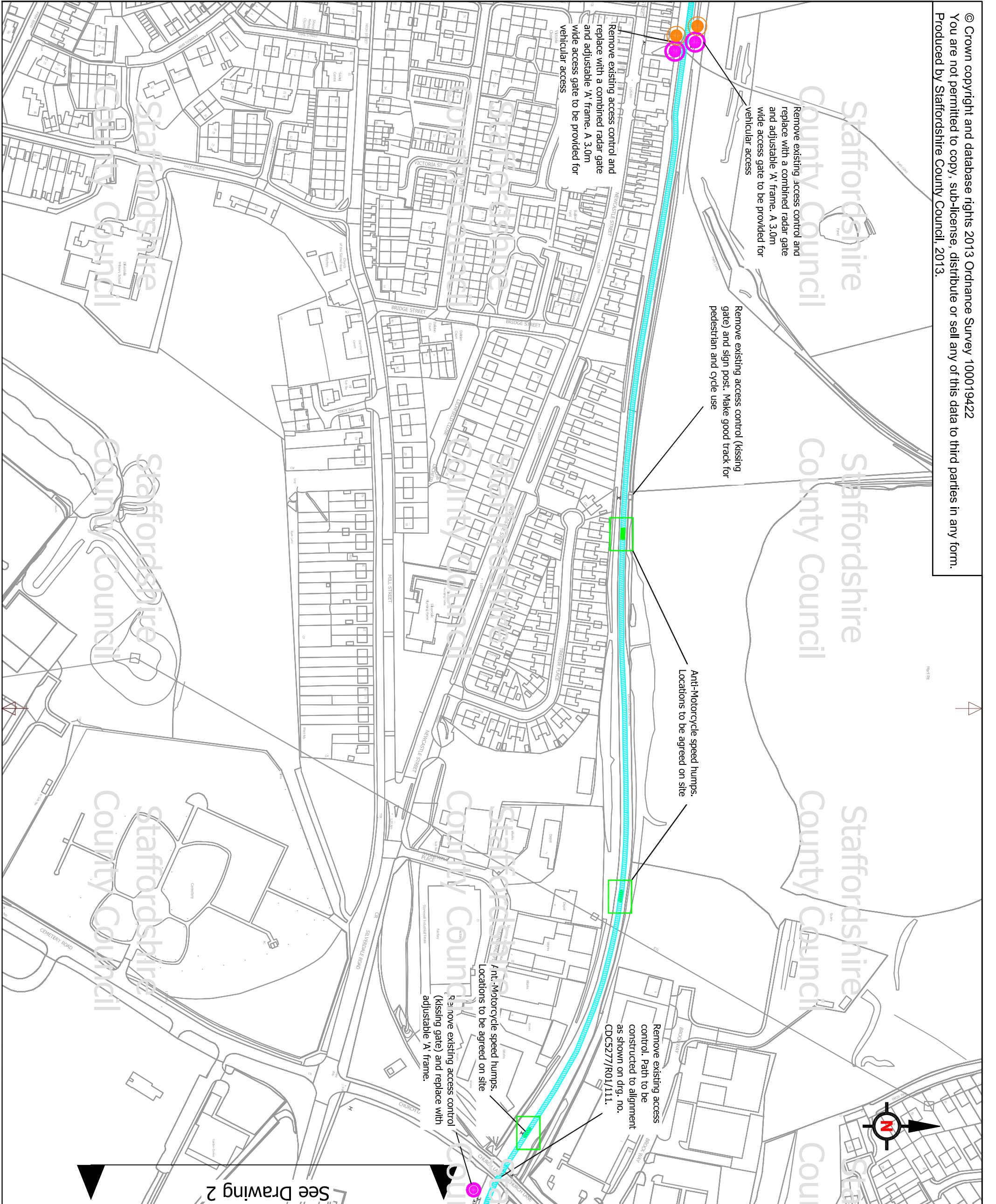

See Drawing 2

**Key**

Adjustable 'A' frame and gate with radar lock

Vehicular access gate

Chicane

Anti-motorcycle speed hump

Rev	Date	Detail	By
Revisions			



The Built County - Highways  
 1, Staffordshire Place  
 C/O Wedgwood Building, Tipping Street  
 Stafford  
 ST16 2DH

Lyme Valley North  
 Cycle Links  
 Phase 2

Proposed Work Areas  
 Drawing 3 of 3

Prepared	Produced	Checked	Scale
DMB	DMB	NP	1:2500

Grid Reference

Date  
 August 2013  
 Size  
**A3**

Drawing No. / Revision  
 CDC5277/R01/103 / A

Status  
 Draft