

© Crown copyright and database rights 2013 Ordnance Survey 100019422
 You are not permitted to copy, sub-license, distribute or sell any of this data to third parties in any form.
 Produced by Staffordshire County Council, 2013.

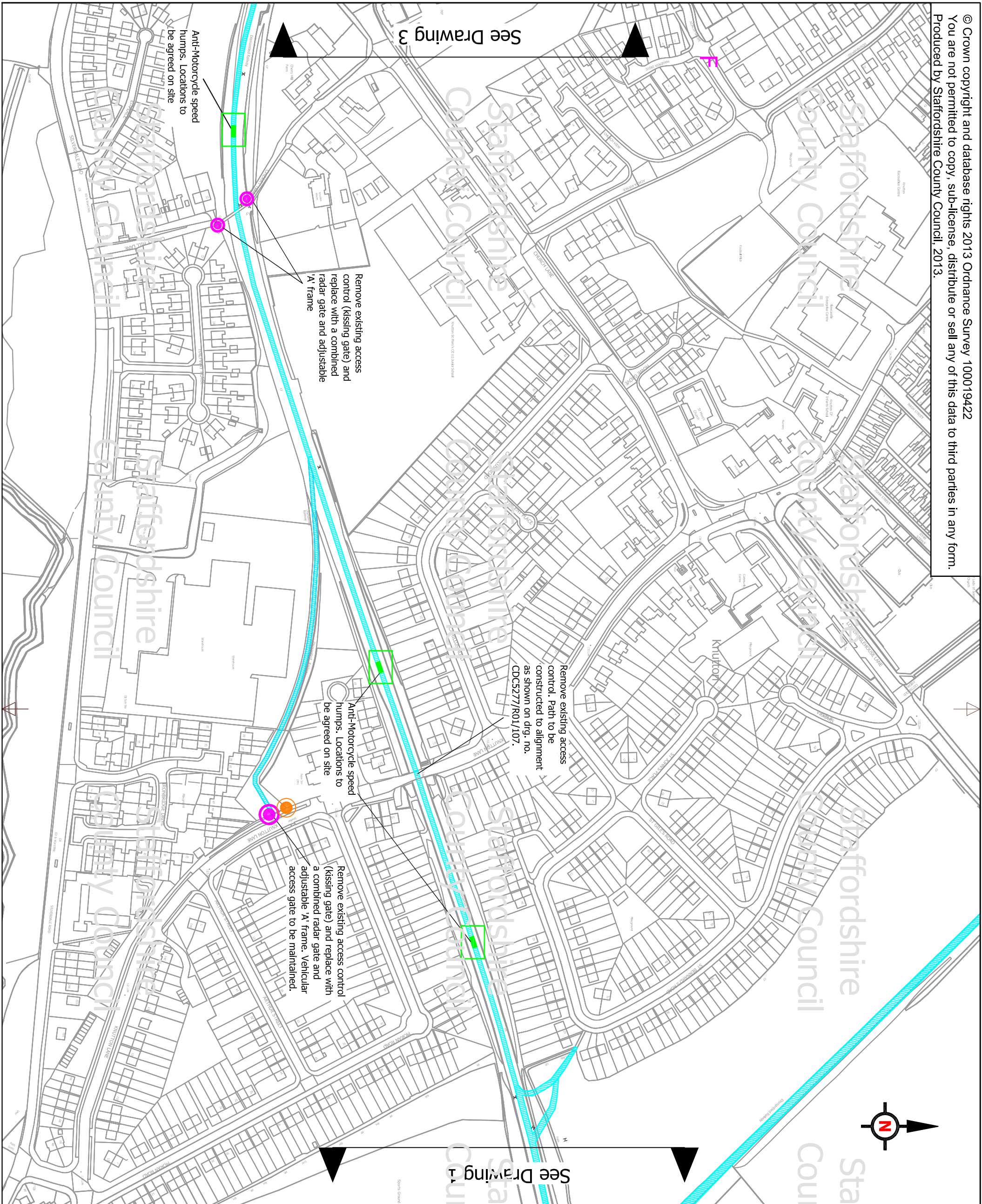

See Drawing 3

See Drawing 1

Key

Adjustable 'A' frame and gate with radar lock

Vehicular access gate

Chicane

Anti-motorcycle speed hump

Rev	Date	Detail	By
Revisions			



The Built County - Highways
 1 Staffordshire Place
 C/O Wedgwood Building, Tipping Street
 Stafford
 ST16 2DH

Lyme Valley North
 Cycle Links
 Phase 2

Proposed Work Areas
 Drawing 2 of 3

Prepared	Produced	Checked	Scale
DMB	DMB	NP	1:2500
Grid Reference			

Date: August 2013
 Size: A3

Drawing No.: CDC5277/R01/102
 Revision: A

Status: Draft